

TRAINING MANUAL SHEET 105-R
 STOCKTON YARD - TRACK DIAGRAM
 LOCATION OF FEATURES OF SHEETS 109J TO 109N
 (Cont'd.)

	SHEET NO. 109:-	NEAREST MILEPOST NUMBER
Western Pacific		
Warehouse	L	
Western Warehouse Co.	L	
West Yard	K	91.50
Wharf Tracks #1, 2, 3, 4, 6 & 7	L	
Wilshire Ave.	N	
Worth St.	K	93.00
Yard Office	K	92.00
Yosemite St.	N	

TRAINING MANUAL SHEET 106-A
 OROVILLE YARD - TRACK DIAGRAM
 LOCATION OF FEATURES OF OROVILLE YARD TRACK
 DIAGRAM, SHEETS 109P & 109Q, BY APPROXIMATE
 MILEAGE FROM SAN FRANCISCO.

Mileage from San Francisco is shown on Track
 Diagram by M.P. numbers every 1/4 mile.

	SHEET NO. 109:-	NEAREST MILEPOST NUMBER
Adelaide	P	202.75
Adelaide (BKR) Spur	P	202.75
Arboretum	Q	205.00
A. Vaughn & Sons	Q	204.50
Baggett - Marysville Rd.	P	203.00
Baldwin Ave.	Q	205.00
Bird St.	Q	205.25
B. K. R. Spur	P	202.75
Bridge St.	Q	205.25
Caboose Tracks	P	202.50
Car Dept. Lockers	P	202.75
Car Shantys	P	203.00
and	P	203.50
Coach Track	Q	205.25
Cow Track	P	202.75
Depot	Q	205.00
Diesel Fuel Spur	P	203.00
Diesel Fuel Tank	P	203.00
Diesel Leads	P	203.00
Drill Track, East	P	203.75
to	Q	204.50
Drill Track, West	P	202.50
East Drill Track	P	203.75
to	Q	204.50
Ehmans Spur	Q	204.50
Electric Shop	P	203.00
Feather River	Q	205.50
First St.	Q	204.75
Freight House	Q	205.00
Fuel Oil Storage Tank	P	202.75
Fuel Oil Tank	P	203.00
Garden Tracks	P	203.00
Grace St.	Q	204.75
Grant Ave.	Q	204.75
High Sierra Pine Mill	Q	204.25
High St.	Q	205.00
Highway #40 Alt.	Q	205.50
Highway #40 Alt. Bypass	Q	204.25
H. J. Kaiser Co., Adelaide Plant	P	202.25
Hoke Fuel Co.	Q	204.50

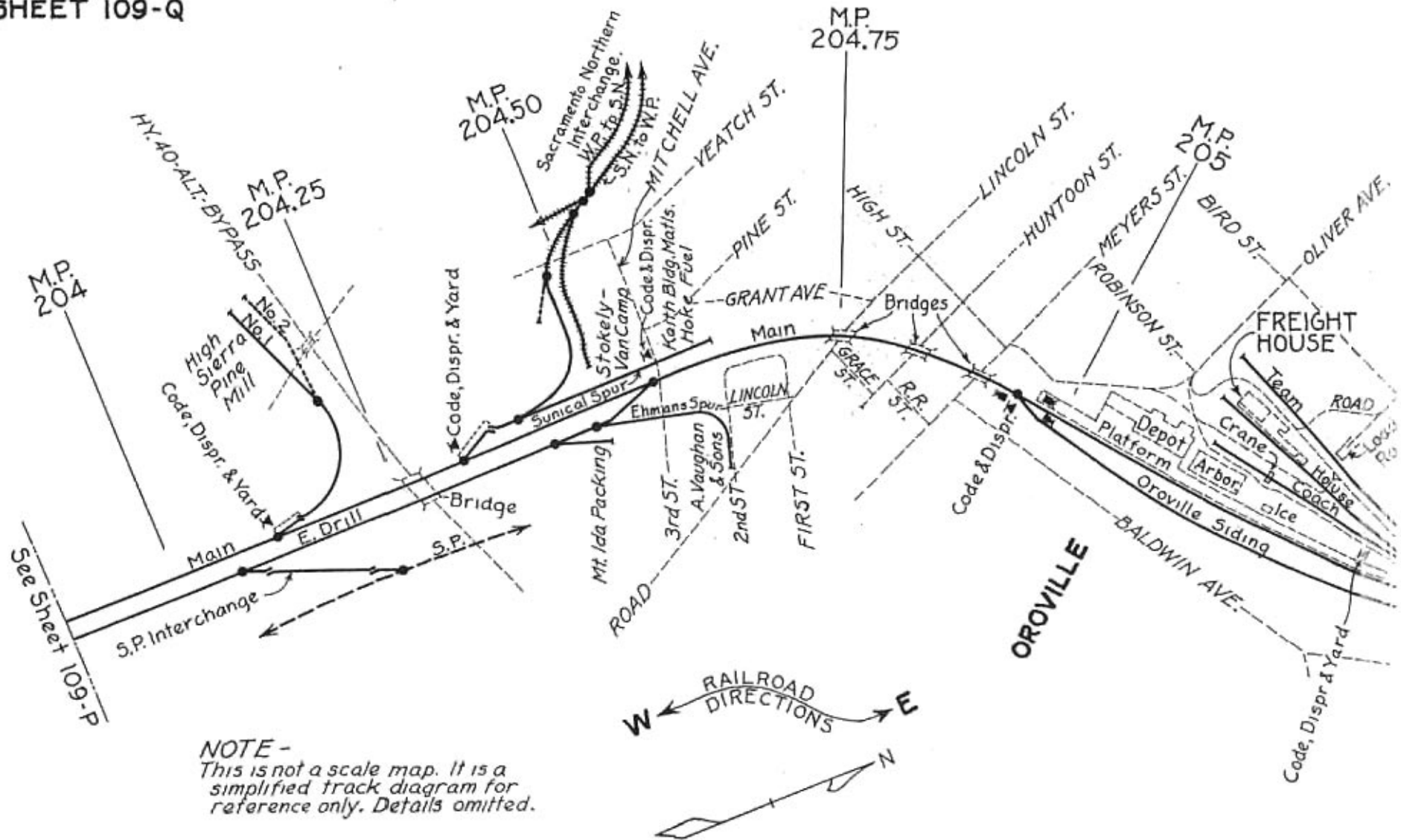

NOTE -
 This is not a scale map. It is a simplified track diagram for reference only. Details omitted.

M.P. 203

M.P. 203.25

M.P. 203.50

M.P. 203.75

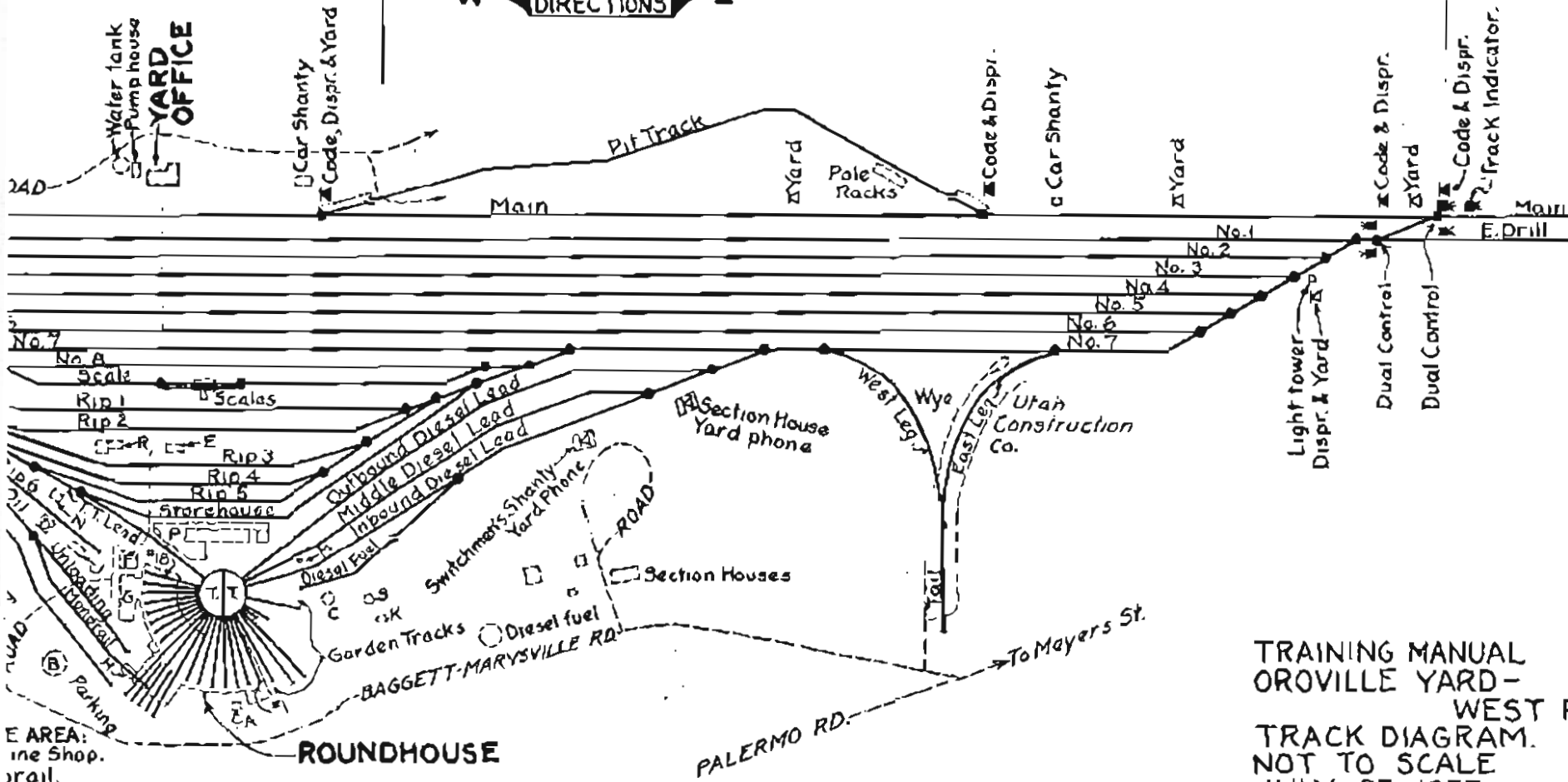
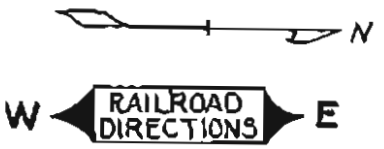

- E AREA:
- ine Shop.
 - rail.
 - t Shop.
 - p House.
 - t Tower.
 - mill.
- P-Storehouse & Platform.
 R-Toolhouse & Workshop.
 S-Water Tank.
 TT-Turntable.

ROUNDHOUSE

TRAINING MANUAL 109-P
 OROVILLE YARD -
 WEST PART.
 TRACK DIAGRAM.
 NOT TO SCALE
 JULY 25, 1955 K.W.R.

See Sheet 109-Q

SHEET 109-P

Spur to:
National Wood Treating.
Oroville Lumber (High Sierra).
Pony Express Stud.
H.J. Kaiser-Adelaide Plant.

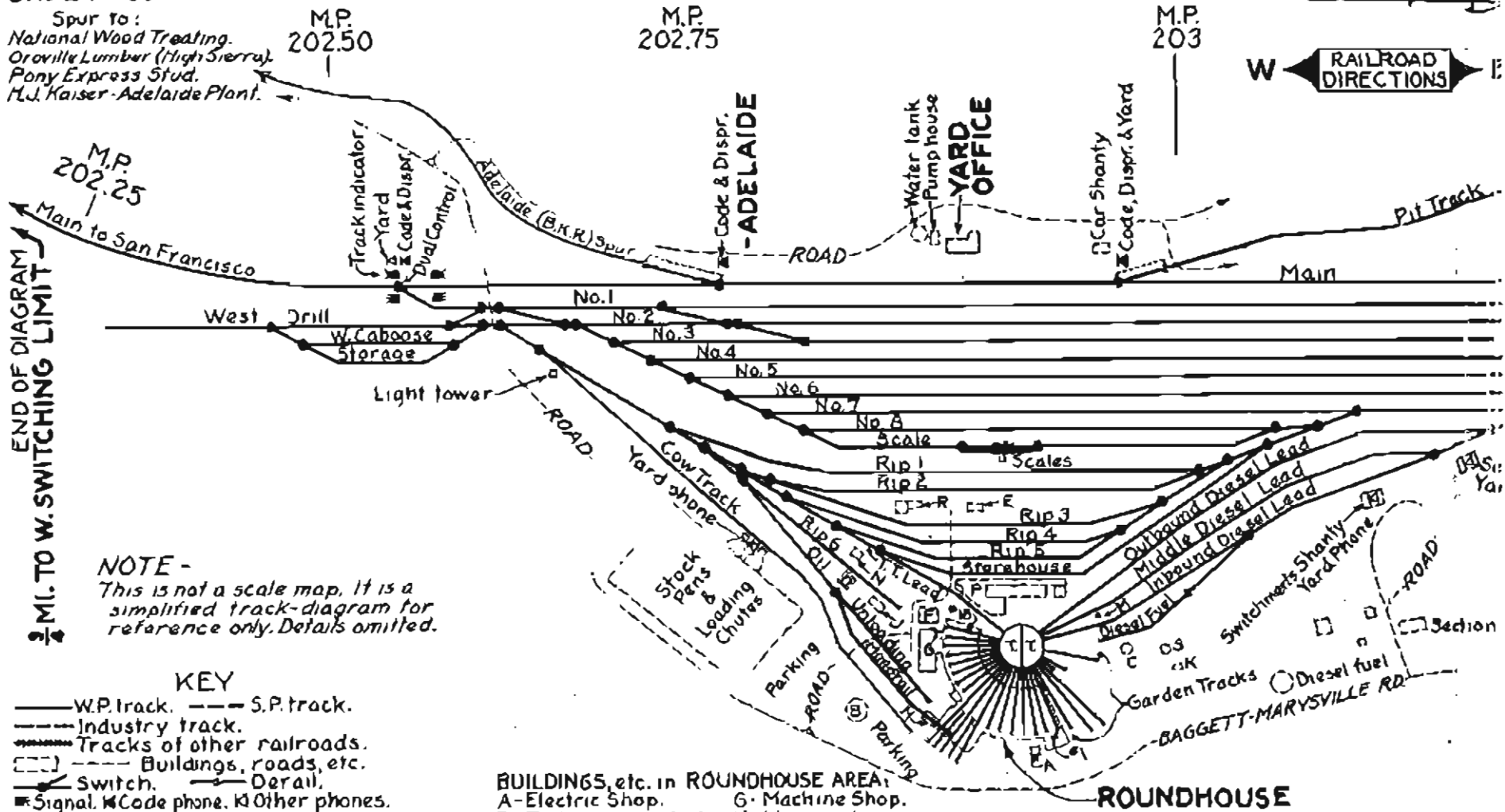

NOTE -
This is not a scale map, it is a simplified track-diagram for reference only. Details omitted.

KEY

- W.P. track. - - - S.P. track.
- Industry track.
- Tracks of other railroads.
- ▭ Buildings, roads, etc.
- ⚡ Switch. — Detail.
- Signal. ☎ Code phone. ☎ Other phones.

See Sheet 109 and Sheet 106-A (Index).

- BUILDINGS, etc. in ROUNDHOUSE AREA:**
- | | | |
|----------------------------|-------------------|----------------------------|
| A - Electric Shop. | G - Machine Shop. | P - Storehouse & Platform. |
| B - Fuel oil storage tank. | H - Monorail. | R - Toolhouse & Workshop. |
| C - Fuel oil tank. | J - Paint Shop. | S - Water Tank. |
| D - Lockers - Car Dept. | K - Pump House. | TT - Turntable. |
| E - Oil House. | M - Sand Tower. | |
| F - Office. | N - Sawmill. | |

TRAINING MANUAL SHEET 106¹B
 OROVILLE YARD - TRACK DIAGRAM
 LOCATION OF FEATURES OF OROVILLE YARD TRACK
 DIAGRAM, SHEETS 109P & 109Q, BY APPROXIMATE
 MILEAGE FROM SAN FRANCISCO.

Mileage from San Francisco is shown on Track
 Diagram by M.P. numbers every 1/4 mile.

	SHEET NO. 109:-	NEAREST MILEPOST NUMBER.
House Track	Q	205.25
Huntoon St.	QQ	204.75
Inbound Diesel Lead	P	203.00
Interchange - S.N.	Q	204.50
Interchange - S.P.	Q	204.00
Keith Building		
Materials Co.	Q	204.50
Light Towers	P	202.75
	and P	203.75
Lincoln St.	Q	204.75
Loading Chutes	P	202.75
Loading Ramp	Q	205.25
Machine Shop	P	202.75
Meyers St.	Q	205.00
Middle Diesel Lead	P	203.00
Mitchell Ave.	Q	204.50
Monorail	P	202.75
Monorail Spur	P	202.75
Montgomery St.	Q	205.25
Mount Ida Packing Co.	Q	204.50
National Wood Treating Co.	P	202.25
Oil Unloading Spur	P	202.75
Oliver Ave.	Q	205.00
Oroville Lumber Co. (High Sierra)	P	202.25
Oroville Siding	Q	205.25
Oroville Station	QQ	205.00
Outbound Diesel Lead	P	203.00
Paint Shop	P	202.75
Palermo Road	P	203.25
Pine St.	Q	204.50
Pit Track	P	203.25
Pole Racks	P	203.25
Pony Express Stud Co.	P	202.25
Pump Houses	P	203.00
Railroad St.	Q	204.75
Rip Tracks	P	203.00
Robinson St.	Q	205.00
Roundhouse	P	203.00
Sand Tower	P	203.00

TRAINING MANUAL SHEET 106-C
 OROVILLE YARD - TRACK DIAGRAM
 LOCATION OF FEATURES OF OROVILLE YARD TRACK
 DIAGRAM, SHEETS 109P & 109Q, BY APPROXIMATE
 MILEAGE FROM SAN FRANCISCO.

Mileage from San Francisco is shown on Track
 Diagram by M.P. numbers every 1/4 mile.

	SHEET NO. 109:-	NEAREST MILEPOST NUMBER
Sawmill	P	202.75
Scales	P	203.00
Second St.	Q	204.75
Section Houses	P	203.25
S.N. Interchange	Q	204.50
S.P. Interchange	Q	204.00
Stock Pens	P	202.75
Stokely-Van Camp, Inc.	Q	204.50
Storage Caboose Track	P	202.50
Storehouse & Storehouse Track	P	203.00
Sunical Spur	Q	204.50
Switchmens Shanty	P	203.00
Team Track	Q	205.25
Third St.	Q	204.50
Toolhouse & Workshop	P	202.75
Turntable Lead	P	202.75
Utah Construction Co.	P	203.50
Veatch St.	Q	204.50
Ward St.	Q	205.25
Water Tanks	P	202.75
	and P	203.00
West Caboose Track	P	202.50
West Drill Track	P	202.50
Wye	P	203.25
Yard Office	P	203.00

KEY

- W.P. track
- S.P. track.
- Industry track.
- Tracks of other railroads.
- Buildings, roads, etc.
- Switch
- Derail.
- Signal.
- ◀ Code phone
- ◀ Other phones.

See Sheet 109 and Sheet 106-A (Index).

